



**FRESENIUS
KABI**

caring for life

How to use the Freka[®] Stoma Measuring Device

For selecting the length of a Freka Belly Button ≥ 12 FR



Getting ready

- Always refer to local guidelines
- Collect all equipment needed on a clean table or tray
 - Freka[®] Stoma Measuring Device (Product code 7750921)
 - A 10ml luer slip syringe to remove water from current device
 - Non-sterile gloves
- Wash hands thoroughly with soap and water before and after carrying out this procedure
- The length of the stoma should be checked with the patient in supine and sitting position.
- Remove the patient's current device following manufacturer's instructions

Instructions for use

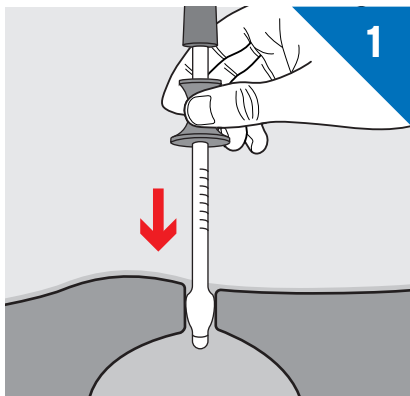

1 Insert the Stoma Measuring Device carefully through the stoma into the stomach.

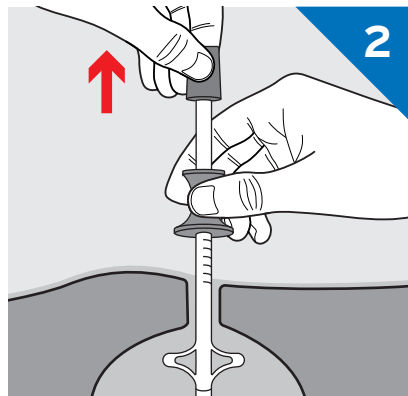

2 Pull the handle which will unfold a retention mechanism in the stomach.

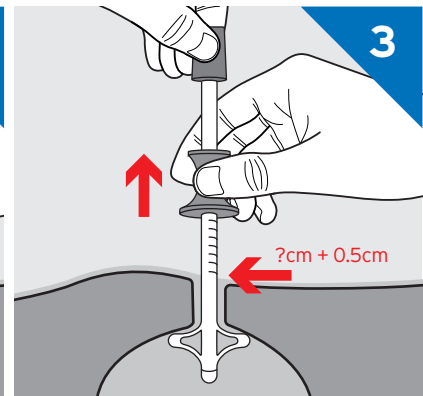

3 The Stoma Measuring Device is then withdrawn until slight resistance is felt. Now the stoma length can be read.

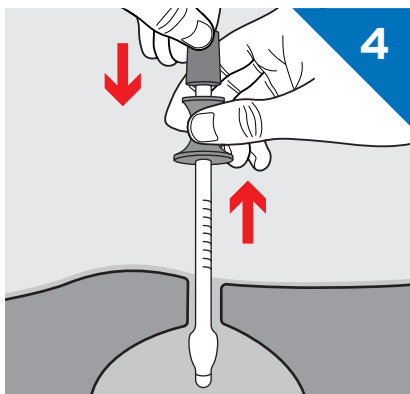

4 Push the handle back down to stretch the retention device. The Stoma Measuring Device can then be removed.

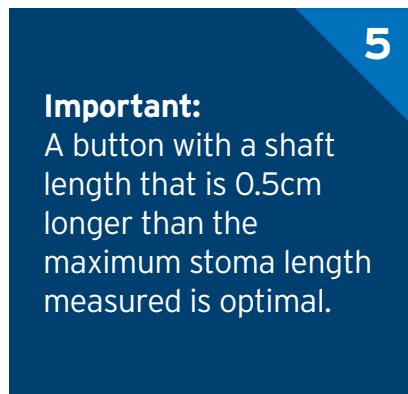

Important:
A button with a shaft length that is 0.5cm longer than the maximum stoma length measured is optimal.

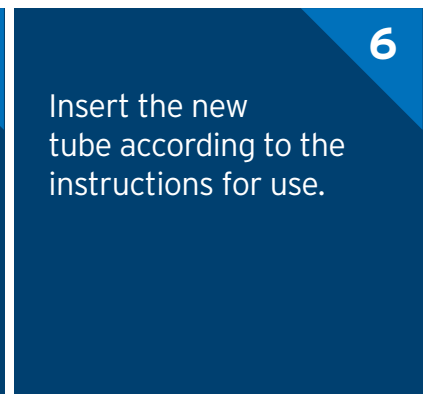

6 Insert the new tube according to the instructions for use.